

# WATCHDOG CLAMPS AND BRACKETS

Attach Roll-Up or Rigid Signs To Watchdog Sign Stands



## Roll-Up Sign Clamps & Brackets



Universal Bracket  
Part # SH-RSMC  
fits masts 1" to 1.5"  
Part # SH-RSMC-SM  
fits masts 3/4" to 1"



Quick Grip™ Clamp  
attaches to Roll-Up Sign Rib  
Part # 3SQ-RSC



Fast Bracket™  
Part # SH-RMQR  
fits masts 1" to 1.5"



Fast Bracket™  
Part # SH-RMQR-SM  
fits masts 3/4" to 1"

## Rigid Sign Brackets

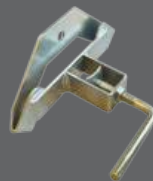

Rigid Sign Brackets  
Part # SH-HSHL-96  
Part # SH-HSL-95  
fits masts up to 1.5"



Rigid Sign Brackets  
Part # SH-HSHL-08  
fits masts up to 1.25"  
Part # SH-HSHL  
fits masts up to 1.5"



Rigid Sign Bracket  
Part # SH-HSHL-SM  
fits masts 3/4" to 1"

### SIGN STAND BRACKET INFORMATION CHART

Sign Stand Model #	Rigid Sign Bracket Options		Roll-Up Sign Bracket & Clamp Options
	Use At <i>Top</i> of Rigid Sign	Use At <i>Bottom</i> of Rigid Sign	<b>*Ships with Sign Stand</b>
SS400	SH-HSHL-SM	SH-HSHL-SM	SH-RSMC-SM, 3SQ-RSC, SH-RMQR-SM
SS410A	SH-HSHL-96	SH-HSHL-96	<b>*SH-RSMC</b> , 3SQ-RSC, SH-RMQR
SS420A	<b>*SH-HSHL-08</b> SH-HSHL-96	<b>*SH-HSHL</b> SH-HSL-95	SH-RSMC, 3SQ-RSC, SH-RMQR
SS440	SH-HSHL-SM	SH-HSHL-SM	SH-RSMC-SM, 3SQ-RSC, SH-RMQR-SM
SS620A	SH-HSL-95	SH-HSL-96	SH-RSMC, SH-RMQR
SS621A	<b>*SH-HSL-95</b>	<b>*SH-HSHL-96</b>	SH-RMQR, SH-RSMC
BC-12-RG-KIT	<b>*SH-HSL-95</b>	<b>*SH-HSL-95</b>	
BC-12-FB-KIT			<b>*SH-RMQR</b>
BC-15-RG-KIT	<b>*SH-HSL-95</b>	<b>*SH-HSL-95</b>	
BC-15-FB-KIT			<b>*SH-RMQR</b>

# QUICK GRIP™ CLAMP

## Comes Attached to Roll-Up Cross Brace For Fast Sign Deployment

- 3 rivets used to attach to horizontal cross brace
- Fits sign stand masts 3/4", 1", and 1 1/4" square tube
- Zinc plated

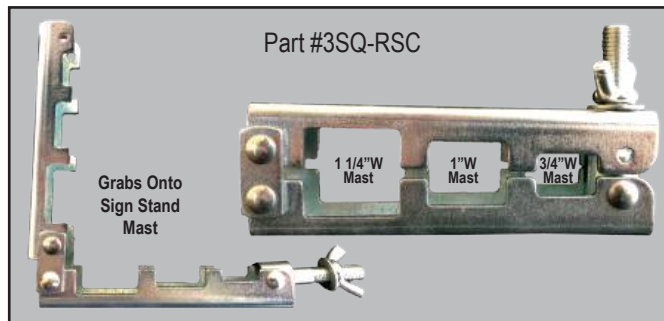

- Quickly and securely attach roll-up signs to your sign stand
- Slide bracket onto mast and tighten using crank to keep in place
- Easy snap on design, pull back on handle to release
- Part #SH-RMQR-SM fits sign stand masts 3/4" to 1" (square tube)
- Part #SH-RMQR fits sign stand masts 1" to 1 1/2" (square tube)
- Zinc plated

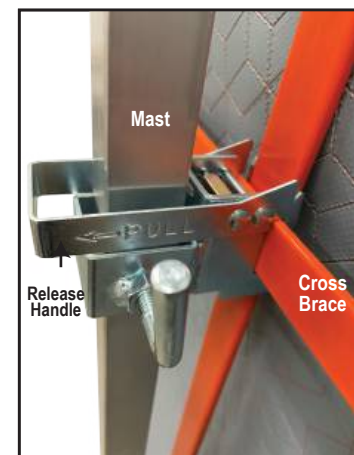
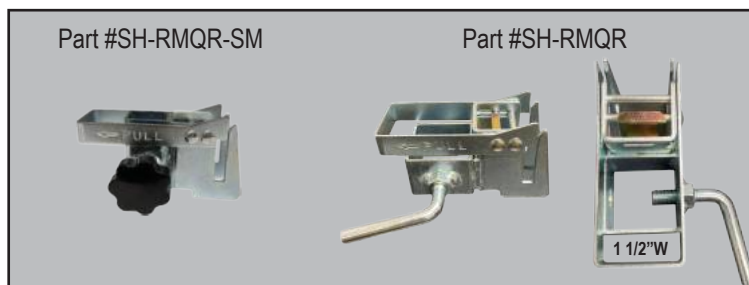

# UNIVERSAL BRACKET FOR ROLL-UP SIGNS

- Part #SH-RSMC-SM fits sign stand masts 3/4" to 1" (square tube)
- Part #SH-RSMC fits sign stand masts 1" to 1 1/2" (square tube)
- Zinc plated



**PLASTICADE®**

100 Howard Avenue  
Des Plaines, IL 60018  
phone (800) 772-0355  
info@plasticade.com

[Plasticade.com](http://Plasticade.com)