



Increase your visibility.

# UTILITY & INDUSTRIAL SAFETY PRODUCTS





### Compact Sign Stands

### High Mount Sign Stands



### Tripods & Barrier Mount Sign Stands



### Sign Stand Guide

Model #	SSRB800	SS300	SS300A	SS310	SS310A	SS340A	SS400	SS410A	SS420A	SS440	SS620A	SS621A	SS100	SS105	BC-12 & BC-15
Roll-Up Sign	Yes	Yes	Yes	Yes	Yes	Yes	Yes	Yes	No	Yes	Yes	No	No	No	Yes
Rigid Sign	No	No	No	No	No	No	No	No	Yes .080 Alum.	No	Yes 10 mm Cor.	Yes .080 Alum.	Yes 5/8" ply	Yes 5/8" ply	Yes
Main Material	Rubber	Powder Coated Steel	Alum.	Powder Coated Steel	Alum.	Alum.	Powder Coated Steel	Alum.	Alum.	Powder Coated Steel	Alum.	Alum.	Galv. Steel	Powder Coated Steel	Powder Coated Steel Clamp Alum. Mast

\* BC-12 & BC-15 not MASH Tested



## LEG RELEASE SYSTEM

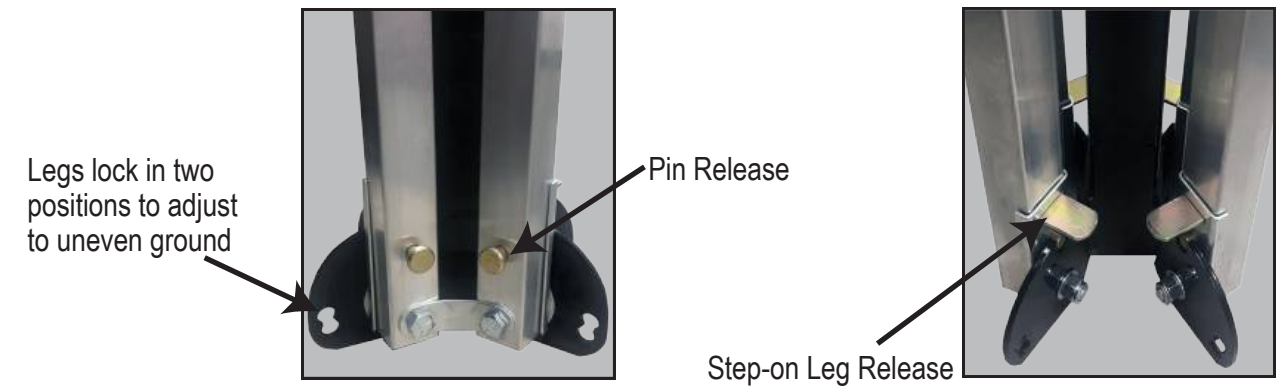

Both Pin and Step-On Leg Releases are Standard on all Sign Stands (except for Tri-Pods & Barrier Clamp)

## STANDARD SIGN HOLDERS (see page 10 for additional options)



Universal Bracket For Roll-Up Signs



Zinc Plated



Brackets for Rigid Signs (U.S. Patent 10,546,515)



Zinc Plated

Universal Sign Clamp for Roll-Up Signs (patent pending)

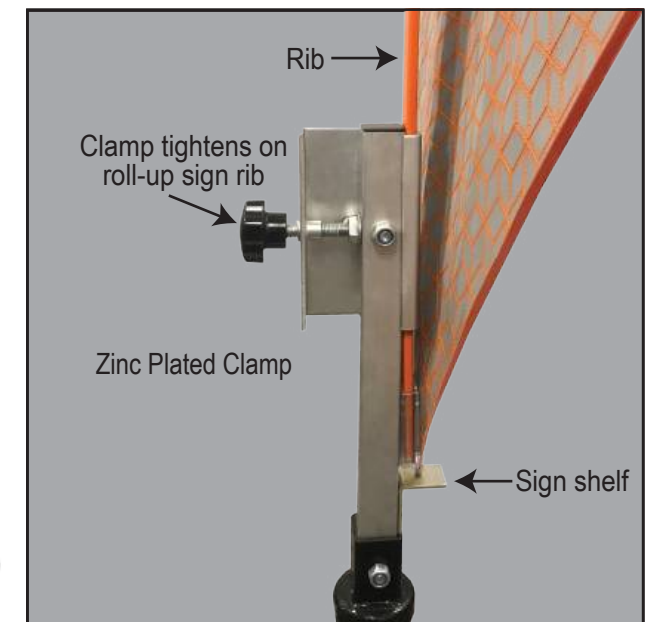

## HEAVY DUTY SPRINGS

- Automotive grade springs
- designed to perform in extreme weather conditions without fatiguing or breaking
- E-coated for maximum rust and corrosion resistance
- Zinc plated nuts and bolts



 **MASH APPROVED**



**SPRINGLESS SIGN STAND**



**SINGLE SPRING SIGN STAND**



**COMPACT DOUBLE SPRING SIGN STAND**



**TALL DOUBLE SPRING SIGN STAND FOR ROLL-UP SIGNS**



**MEDIUM HEIGHT SPRINGLESS SIGN STAND FOR ROLL-UP SIGNS**



**HEAVY DUTY DOUBLE SPRING SIGN STAND FOR RIGID SIGNS**



**TRIPOD SIGN STANDS**



**INTREPID™ RUBBER BASE SIGN STAND FOR ROLL-UP SIGNS**

**SNAP N PACK™ ROLL-UP**

Sign folds up easily and snaps open!  
Deploy in seconds on a compact sign stand.

- Wear Resistant Ink!
  - ink won't transfer to sign where it doesn't belong
- Roll-up Signs 36" & 48"
- Reflective in orange, yellow, and pink
- Non Reflective, orange
- Fiberglass Cross Braces
  - 3/8" Vertical Brace with 3/16" horizontal brace
- Durable Polycarbonate Corner Pockets
- Standard and Custom Legends Available

**Perfect Product For First Responders!**



**Sign Slides Onto Universal Roll-Up Sign Bracket**

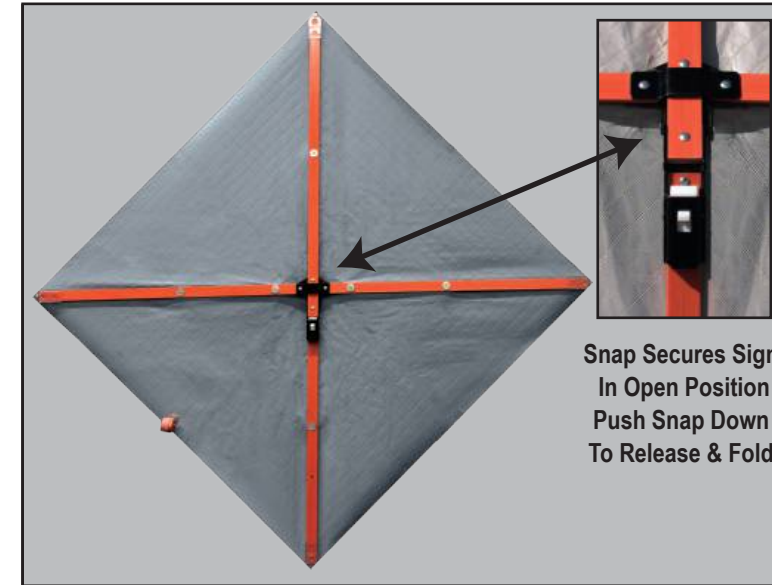

**Snap Secures Sign In Open Position Push Snap Down To Release & Fold**



**Carry Bags Available Holds Sign Stand with Snap N Pack Roll-Up Sign attached and ready to deploy**

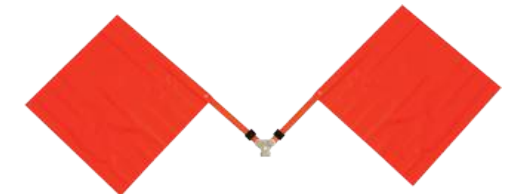

**Optional Folding Flag Attachment**

- Riveted to vertical brace
- Folds up with the sign for storage

- Use the Snap N Pack™ Roll-Up sign with our MASH Accepted Watchdog Compact Sign Stands
- Fits any stand with a universal roll-up sign bracket
  - Recommended Sign Stands
    - SS310A for 36" x 36" Signs
    - SS340A for 48" x 48" Signs



## PVC TRAFFIC CONES



Standard - 36", 28", & 18"  
Slimline 28" & 36"

High visibility PVC injection molded cones, durable and reboundable  
 - 36" in 10 lbs. and 12 lbs. fluorescent orange  
 - 28" in 7 lbs. and 10 lbs. fluorescent orange and 7 lbs. lime green  
 - 18" in 3 lbs. fluorescent orange and lime green  
 - Slimline cones in 28" and 36"

Fluorescent orange or lime green color is molded throughout  
 - resists fading  
 - provides high visibility protection

One piece design - cone is permanently molded to black base  
 - won't separate when hit by a vehicle  
 - rubber base designed to grip the road

Hand-grip at top

Stable on the road, won't be blown over

Stackable for storage, no sticking when removed

Recessed areas accept high intensity white collars  
 - 3M™ collars have excellent wide angle retroreflectivity

MASH Accepted, Meets MUTCD Standards

Stenciling Available



Cone Weight Available  
7 lbs.

## TELESCOPING CONE BARS



Two sizes  
 Expands from 4' to 7'  
 - available in reflective orange on white and reflective yellow on black  
 Expands 5.5' to 10', 5 lbs. in reflective orange on white  
 Quick installation to provide high visibility barrier  
 Portable, versatile, & lightweight, 7' - 2 lbs., 10' - 5 lbs.



Twist to lock desired length



## CONE BAR SIGNS



Sign mounts directly to the cone bar  
 - secured with hook and loop fasteners  
 Sign is weighted to remain vertical, even in windy conditions  
 Rolls up neatly and is secured with hook and loop strap for storage  
 - legend printed on edge for ID when rolled  
 Wear resistant ink, crisp lines, no smudging  
 Choose non reflective vinyl or reflective vinyl, white or orange  
 Standard and custom legends available  
 Sign sizes, custom sizes available  
 28"H cones, 18" x 18", 24"W x 18"  
 36"H cones, 24"W x 18", 18"W x 24", 24" x 24"

## GEMSTONE™ VERTICAL PANEL



Oversized handle with comfort grip  
 - can be picked up easily, even with light attached

Thick Flange! Holds onto base  
 - increased rigidity from larger ribbing  
 - eliminates splitting and cracking

Recessed panel protects reflective sheeting - 36"H x 8"W

Flashing light mounting receptacle

Solid recycled rubber base in two sizes

Available in orange, white, and black

Dimensions: 44.5"H x 14.75"W Weight: 4 lbs.

MASH Accepted WZ-300

Meets MUTCD Standards

**New Stronger Flange!**  
 Stands Up To Extreme Heat  
 and Intensive Use

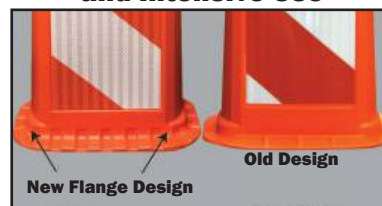

The handle is easy to grab, even with light attached



20 lb. base



30 lb. base

## GRIP TOP™ DELINEATOR

42" H (47.25" with handle)

Large, strong handle is easy to grip  
 - quick placement and pick-up

Post diameter - 4"

Orange polyethylene

Cone bar slips over top

Recessed areas accept two bands of sheeting  
 - protects retroreflective sheeting from rips and scratches

Bright orange for visibility

Flange on bottom grabs base for tight fit

Recycled rubber bases, 8, 10, 12, and 18 lbs.

Weight: 1.6 lbs.

MASH Accepted, Meets MUTCD Standards

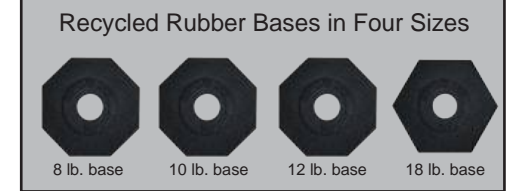

Both Delineator Types Use The Same Bases



Perfect for Cone Bars!

## WATCHTOWER™ DELINEATOR

Watchtower handle has ergonomic, comfort grip  
 - dome cap provides strength and durability  
 - easy placement and pick-up

Two sizes  
 - 42" (47"H with handle)  
 - 28" (33.6"H with handle)

Post diameter - 4"

Recessed areas accept two bands of sheeting  
 - protects retroreflective sheeting from rips and scratches

Flange on bottom grabs base for tight fit

Durable polyethylene  
 - bright orange for visibility

Recycled rubber bases, 8, 10, 12, and 18 lbs.

Weight: 42"H - 1.7 lbs., 28"H - 1.25 lbs.

MASH Accepted, Meets MUTCD Standards



Great for Caution Tape



Easy Grip Handle

## WATCHTOWER™ STACKER CONE

42" tall - compact nesting design

Strong, ergonomic handle  
 - speeds placement on job  
 - fits two hands to make lifting with base easier  
 - string caution tape through handles

Recessed area protects sheeting

Use with 10, 16, or 30 lb. recycled rubber base

Accepts same bases as our Navicade™ delineator  
 - reduces your base inventory

Customize with your company name or logo

Available in orange and yellow

Dimensions: 47.5"H x 11"W  
 Weight: 2.25 lbs.

MASH Accepted, Meets MUTCD Standards

Made in the U.S.A.

Ergonomic handle makes placement of cones easy, even with heavy base



String caution tape through handles



# HYDROCADE™ WATER FILLED BARRICADE SYSTEM

72"L x 32"H longitudinal channelizing device

Unique stacking design allow for up to 50% more units per truckload  
- 200 units per truck, 8 units per pallet

Durable construction, impact resistant

Flat obstruction free side, position to eliminate pedestrian trip hazard

Conforms to any roadway design  
- turns 90° and adjusts to curbs up to a 6° incline

Connector pins snap onto barricade center for storage and transport  
- sturdy and tough pins, built with strength-enhancing channels

Fill with 81 gallons of water for LCD deployable weight of 745 lbs.  
- every unit is leak tested

Two forklift access areas - Stacking lugs keep stacked units from sliding

Light shelf for standard barricade light

Accepts optional fence panels in place of connector pins

Areas for retroreflective striped sheeting, 44" x 8" on both sides

Dimensions: 79" L x 17.5" W x 32" H

Connected length: 72"

Weight: Empty - 67 lbs., Water filled - 745 lbs.

Crash tested for TL-3 MASH Acceptance  
- submitted to FHWA\*

Meets MUTCD Standards

Made in the U.S.A.



TL-3 LONGITUDINAL CHANNELIZING DEVICE\*



**Unique Stacking Design!**  
8 Units/Pallet  
200 Units/Truck

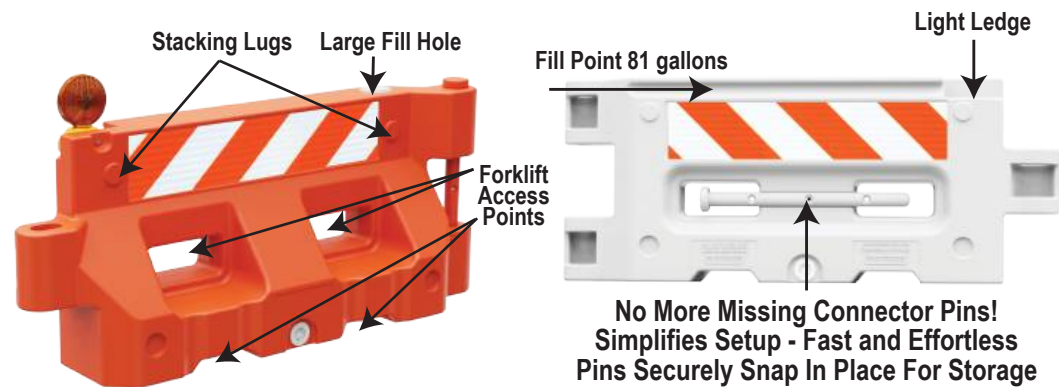

**No More Missing Connector Pins!**  
Simplifies Setup - Fast and Effortless  
Pins Securely Snap In Place For Storage



# ADA PATHCADE™ BARRICADE

**ADA COMPLIANT  
&  
MASH APPROVED**

Multi-purpose Barricade System

- Crowd Control System
- Manhole Guard
- ADA Pedestrian Pathway System
- Longitudinal Channelizing Device

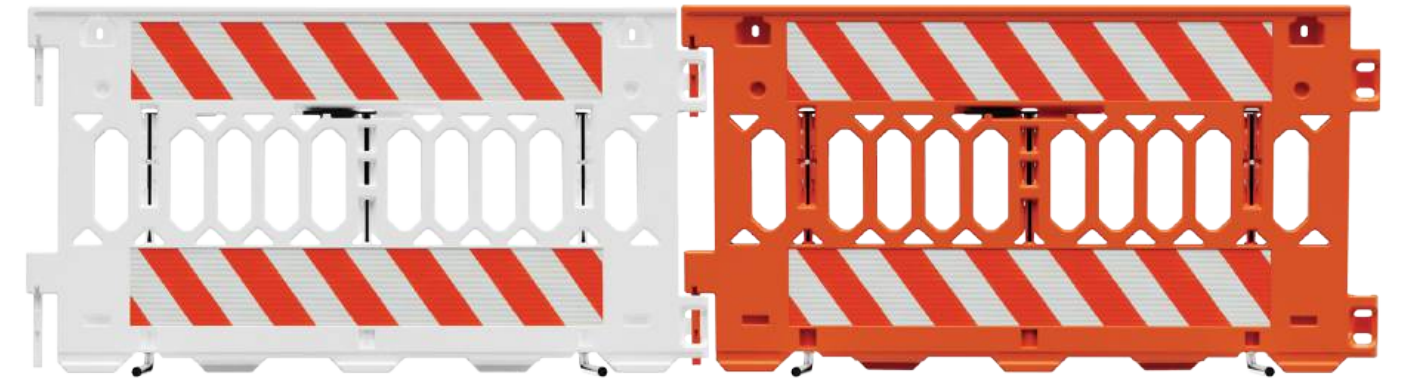

Multi-functional barricade system meets ADA requirements, 72"L x 38"H x 3"D  
- continuously detectable edge at barricade top and bottom

Exclusive tripod leg system, no sandbags needed when using all 3 feet

- anti-trip foot on one side
- two larger feet on other side
- use only larger feet with sandbags for ADA Compliance

Easy handle turn deploys barricade feet!

- unique soft grip handle system, quick turn moves feet out or back in

Stack 20% more

- nesting system allows for 19 units to be stacked on pallet
- lowers transportation costs
- stacking lugs keep stacked units from shifting

Shape to any layout, units pivot 120°

- 3 units in triangle layout for manhole guard

Robust dual connectors create easy to use linking system

Smooth, comfortable guardrail  
- rounded edge on top of panel

Four recessed sheeting areas, two on each side of panel, 8" x 50" ea.

Light shelves hold standard barricade lights, 2 per section

Holes for attaching signage to panel

Available in orange or white, with or without retroreflective sheeting

MASH Accepted, WZ-428, Meets MUTCD Standards

Made in the U.S.A.



Tripod Leg System

Handle turn  
Deploys Feet



Add Signs for  
Crowd Control



Create ADA Compliant  
Pedestrian Pathway



Use Three Units  
To Create Manhole Guard

# ELITE™ PVC FLAGGER POLE

**Pole Segments Slide Together And Are Secured With Spring Loaded Button**

Orange PVC, 1.6" dia. hollow tube, 0.15" thick wall

Two lengths, 72"L and 84"L  
- choose a two or three piece pole

Top segment has 12"L handle and holds the sign

Spring loaded button  
- makes it easy to change from handle to pole to storage

Rounded plastic tip at pole bottom, allows for easy pole turns

Comes with hardware to attach sign, signs sold separately

Meets MUTCD Standards

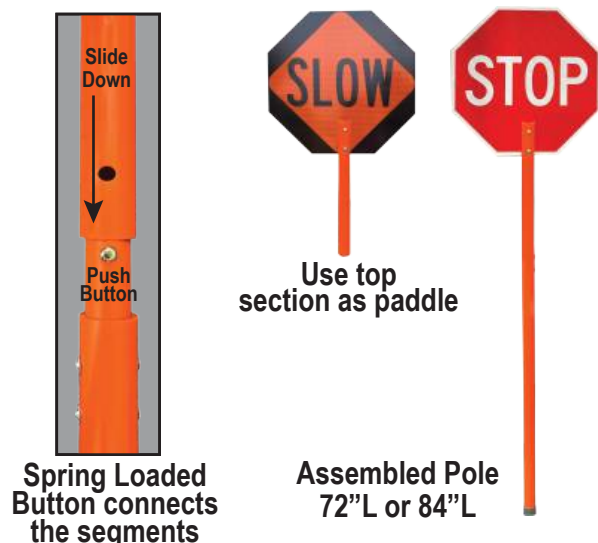
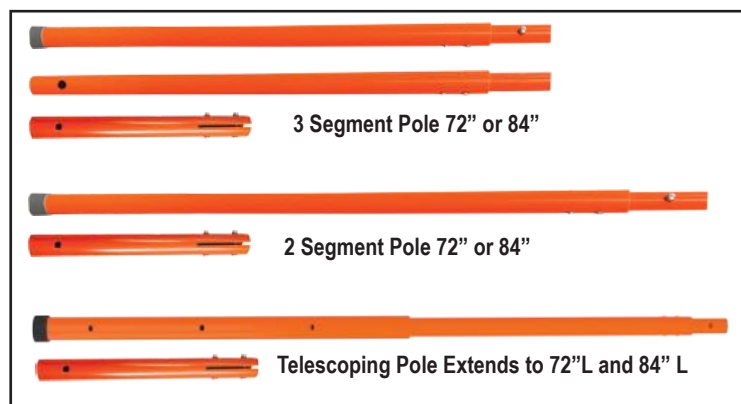

# SAFEKERB SUPAGRIP



Ramp adapts to curb heights from 2.5" to 6"

Withstands loads up to 772 lbs.

Flexible black edge reduces unwanted movement

High visibility, anti-slip, textured surface

Raised sides prevent vehicle run off

Molded plastic won't rust

Stacks compactly for transport and storage

Bolt to road and walkway surface for added stability

Available in yellow

Dimensions: 50.2"L x 29.9"W, 22 lbs.

# SAFEGATE MANHOLE GUARD

**Ideal for Utility Work**



Optional retroreflective sheeting increases visibility

**Non-conductive**

Non-conductive (dielectric), no metal used

Great for protecting any area requiring temporary restriction of access

Hinged clips make it easy to configure sections into rectangles of various sizes

Locking clamp connects straight sections

Folds up easily for storage and sets up quickly

Carry handles for transport

Longer life than metal, replacement sections available

Available in yellow

Dimensions for single section: 39.4"H x 29.5"W, 4.4 lbs.

# TRENCH COVERS

## Trench Covers - 35" & 27"

Two sizes

- designed to cover trenches up to 35" and 27"

Takes the weight of a vehicle up to 4,410 lbs

Anti-slip surface

Deters metal thieves

Beveled edge prevents tripping

Molded from a single piece of fiberglass composite  
- underside has ribbed framework for added strength

Secure with 4 bolts

Available in yellow

35" Trench Cover Dimensions:  
63"L x 47.2"W x 1.18"H, 73 lbs.

27" Trench Cover Dimensions:  
47.2"L x 31.5"W x 0.93"H, 26.5 lbs.

High Visibility, Anti-slip Surface



## Pedestrian Trench Cover

**Ideal for Sidewalk Construction**

For Pedestrians Only - takes up to 553 lbs.

Covers trenches up to 27.5"

Anti-slip surface

Smooth rubber edge greatly reduces tripping hazard

Resists sliding, no need to bolt down  
- flexible material which grips the surface underneath

Available in yellow

Overall Dimensions: 44.3"L x 44.3"W x 0.7"H, 62 lbs.



Lighter than steel,  
stronger than wood



# RUBBER BASE SIGN STANDS

Durable recycled rubber bases  
 - three sizes: 30 lbs., 60 lbs., Stack for 90 lb. base  
 - resistant to weather, oil, salt, moisture, & UV light  
 - will not warp, chip, or crack



Withstands strong winds without tipping over

Molded-in Hand-grips make bases easy to pick up

Optional wheels makes moving signs even easier  
 - heavy duty, non-scratch plastic wheels

Made in the USA

Kit available with plastic square Power Post™ and hardware



**OPTIONAL WHEELS**  
 comes with two double wheel assemblies installed



# SIGN STANDS - SAFETY SIGNAGE

## ① Choose a Sign Stand

- 6 Sizes
- 3 Colors: white, yellow, or orange

 <p><b>Barricades</b>                  Hold signs 24"W x 12"H on top panel                  4 Types:                  Plasticade®                  Fibercade™                  Econocade™                  Combocade™</p>	 <p><b>Squarecade™ 45</b>                  Holds signs 24"W x 24"H                  Dimensions: 45"H x 25"W                  18 lbs.</p>	 <p><b>Squarecade™ 36</b>                  Holds signs 24"W x 24"H                  Dimensions: 36"H x 25"W                  17 lbs.</p>
 <p><b>Narrowcade®</b>                  Holds signs 12"W x 24"H                  Dimensions: 45"H x 13"W                  11 lbs.</p>	 <p><b>Minicade®</b>                  Holds signs 12"W x 24"H                  Dimensions: 36"H x 13"W                  10 lbs.</p>	 <p><b>Signicade®</b>                  Holds signs 24"W x 36"H                  Dimensions: 45"H x 25"W                  18 lbs.</p>

## ② Choose a Sign Legend

- Over 100 Standard Designs
- Custom Design Your Own Sign

## ③ Plasticade will Professionally Apply the Legend to the Sign Stand

- Hassle Free
- Guaranteed Application



# FLAGGER STATION & WORK AREA LIGHTING

8 foot light elevation

Collapsible aluminum extension mast  
- cam lock adjustments with retractable cable

Battery rated for 500+ charge cycles  
- push to test voltage meter

DC Power Port  
- operate unit with external 12 VDC power  
- run other DC powered electrical devices

Charge with clamp style jumper cables  
- can jump start vehicle

Lamp heads are independently, directionally adjustable

Yellow LED flasher on unit for added safety

Legs stable on uneven ground, retract for storage

Weatherproof case

Lifetime warranty on light heads

One year replacement warranty on battery and charger

Weight: 44 lbs. Storage Dimensions: 26"H x 17.5"W x 8"D



Sets Up  
In Seconds



Dual LED Light Head  
4000 Total Lumens (2,000 each light head)  
24 Watts, 2 amps, for the two heads  
Full Charge Run Time:  
• 14+ hrs. with both light heads on  
• 25+ hrs. with one light head on

**WARNING**  
This product contains a sealed lead acid battery which can expose you to chemicals including Lead and Sulfuric Acid, which are known to the State of California to cause cancer and birth defects or other reproductive harm.  
For more information go to [www.P65Warnings.ca.gov](http://www.P65Warnings.ca.gov)



115 VAC power and DC to DC power cords included



Charge DC Powered Electrical Devices (DC computer adapter not included)

## Internal Battery Specifications

- 12 VDC sealed 35 amp hour AGM lead acid battery
- Built in 110-240 VAC, 50/60 Hz
- UL approved 3 amp charge system
- Safely stored/operated at -40°F to 140°F
- Recommend continuous charging when light is not in use - if fully depleted, may require 24 hours to fully recharge

## Light Head Specifications

- IP-68 rated dust proof and waterproof
- 60° beam pattern
- Anodized aluminum frame with a polycarbonate lens

# WHEEL CHOCKS

Made in the USA - 100% post-consumer recycled rubber

Will not compress, warp, chip, or crack

UV, oil, and weather resistant

Can be customized

- your name or logo embossed in the chock
- paint for greater visibility and easy identification

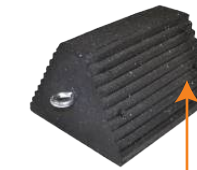
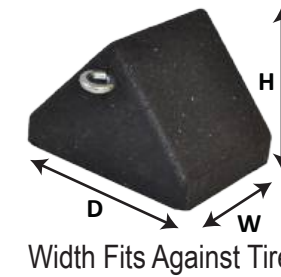

Ridges in chock grip the tire aiding traction on select chock models

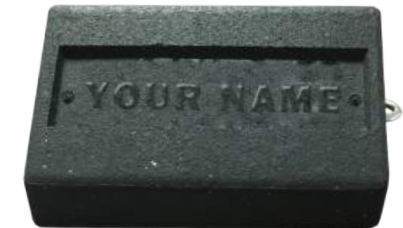

Your Name or Logo Embossed  
200 minimum order quantity

## Automotive & Industrial Chocks Come Standard With Eye bolt



5.25"W x 6.75"D x 4.5"H  
3.5 lbs.



5"W x 9"D x 6"H  
6.5 lbs.



10"W x 8"D x 6"H  
8 lbs.



Painted Chocks for Greater Visibility & Quick Identification  
Standard Colors:  
Orange, Red, Blue, Yellow, White, & Green  
200 minimum order quantity required

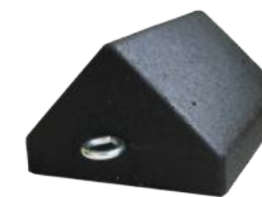

Metal Hairpin Option painted steel 4" x 1.75"

Metal Pole Step Handle Option 7"L galvanized steel



9.75"W x 7.75"D x 5"H  
10 lbs.



10"W x 8"D x 6"H  
11.5 lbs.



6.75"W x 9.25"D x 8"H  
12 lbs.



8.75"W x 8.5"D x 7"H  
15 lbs.



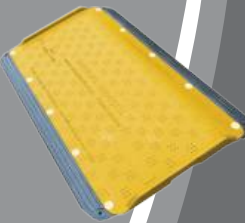
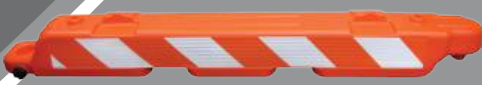
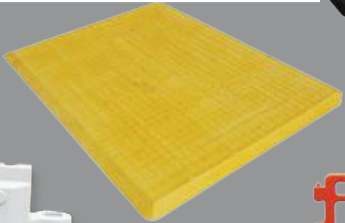
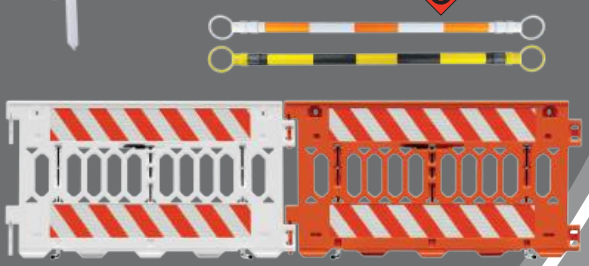

Distributed By: