

HEAVY DUTY DOUBLE SPRING SIGN STAND FOR RIGID & ROLL-UP SIGNS

Mount signs at 84" above ground!

**MASH
APPROVED**

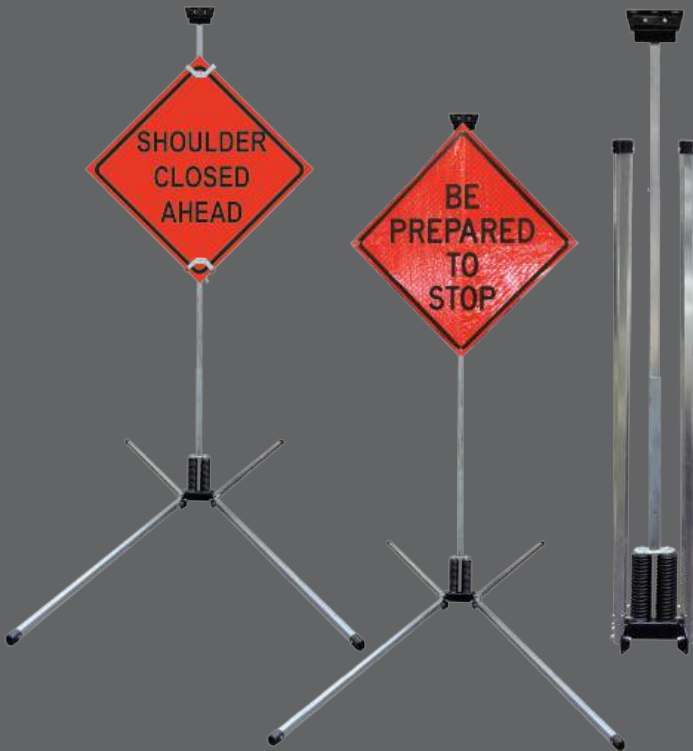

Model SS620A

- Holds rigid and roll-up signs 36" & 48"
- Automotive grade steel, double spring
 - designed to perform in extreme weather conditions without fatiguing or breaking
 - E-coated for maximum rust and corrosion resistance
- Telescoping mast
- Fixed length legs
 - lock in multiple positions to adjust to uneven ground
- Non-skid rubber feet
- Built-in three flag holder
- Replacement parts and assemblies available
- MASH Accepted for 48" 10 mm corrugated plastic signs
 - mount rigid signs at 60" (WZ-424) or 84" (WZ-425) from the ground
- MASH Accepted for 48" roll-up signs
 - mount roll-up signs 84" from the ground (WZ-426)
- Meets MUTCD Standards

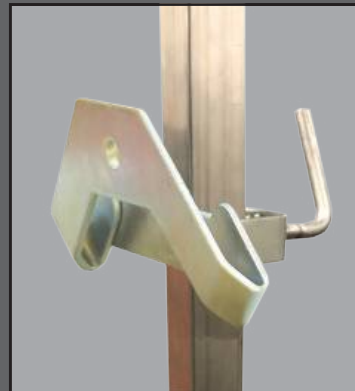

Bracket for Rigid Sign



Bracket for Roll-Up Sign

Zinc Plated Universal Brackets

Rigid brackets for top and bottom of the sign have different clamp sizes to fit around telescoping mast.



Heavy Duty
Double Spring

PLASTICADE®

Plasticade.com

TF062 Rev.8

HEAVY DUTY DOUBLE SPRING SIGN STAND FOR RIGID & ROLL-UP SIGNS

Specs

Material Model SS620A	Aluminum
Roll-Up Sign Mounting Height Top of 48" Sign	84" from ground Top - 152" H maximum
Rigid Sign Mounting Height Top of 48" Sign	60" from ground, Top - 128" H maximum <i>or</i> 84" from ground, Top - 152" H maximum
Carton Size	9" x 12" x 72"
Size Open legs collapsed footprint	legs don't collapse
Size Open legs fully extended footprint	56.4" x 130.6"
Weight	56 lbs.

Rigid Sign Mounting

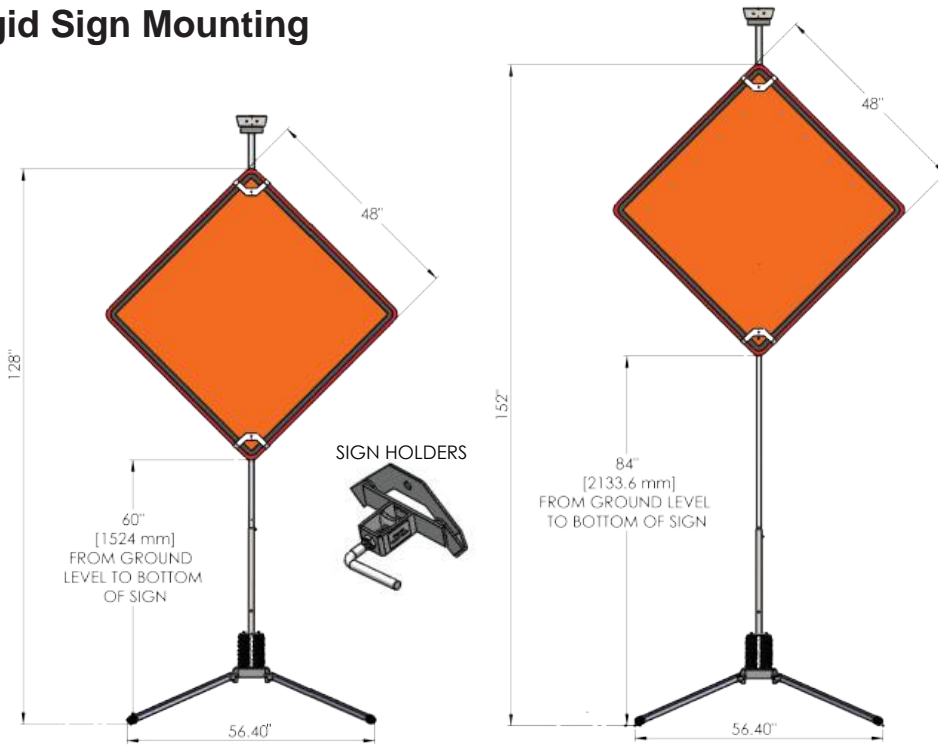

Rigid Sign Bracket - U.S. Patent 10,546,515

Roll-Up Sign Mounting

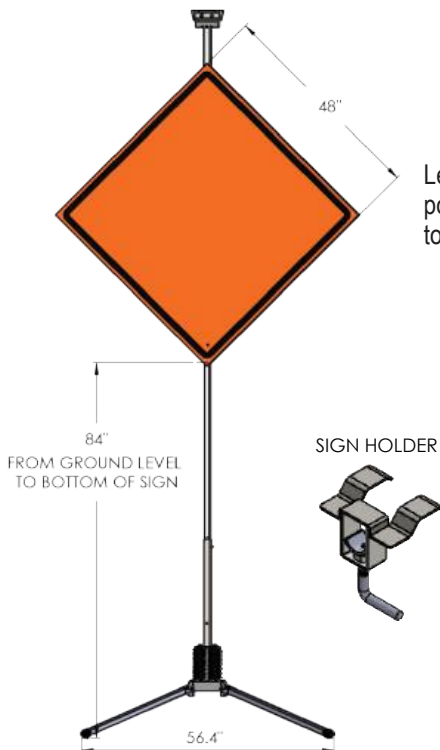

Leg Release System

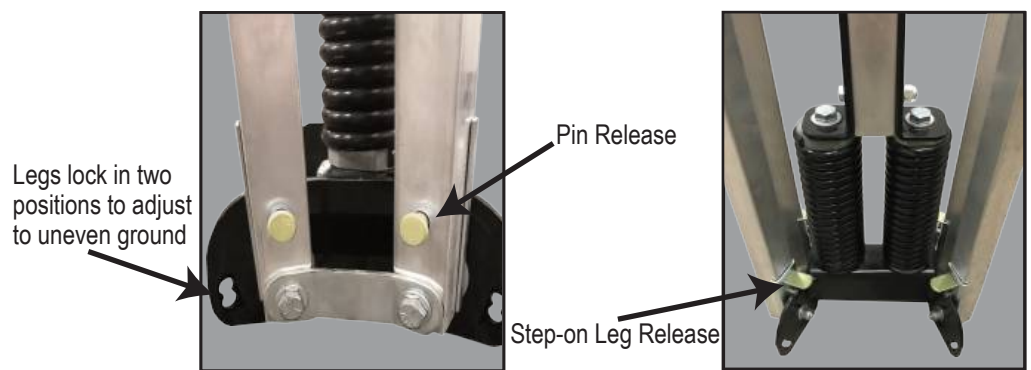

Patent Pending

PLASTICADE®

100 Howard Avenue
Des Plaines, IL 60018
phone (800) 772-0355
info@plasticade.com
Plasticade.com