

The Billboard™

PLASTICADE®

- **Twice as big as a Signicade®**
 - perfect for eye-catching outdoor advertising
- **Six signs per frame**
 - two 36" x 48" signs
 - two side signs
 - two sided top rider
- **360° Messaging**
- **Wheels for easy movement**
 - no installation needed
- **Quick-Change™ Feature**
 - change signs in seconds, slide in a sign
 - use rigid sign material 3/16" thick or less
- "Stay Tabs" hold main signs securely in place
- Internally weight with dry sand
- Available in white and black

Twice as Big
as a
Signicade



Signicade®
6 square feet/side
Main Sign Message Area

The Billboard™
12 square feet/side
Main Sign Message Area



Wheels

The Billboard™

OUTSIDE DIMENSIONS : 58"H X 39"W x 3.125"D

DIMENSIONS OF RECESSED AREA: 46.75"H x 36.25"W

WEIGHT: 45 lbs.

COLORS: White, Black, Custom Colors Available

6 SIGNS PER FRAME

Main Signs Insertion Instructions:

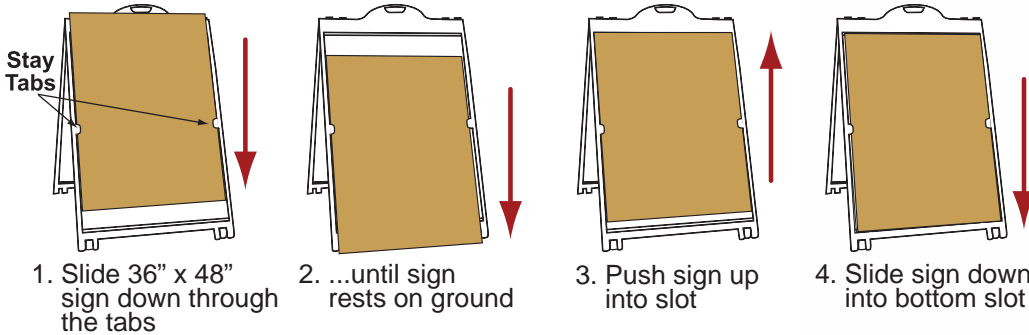

Top Rider Insertion Instructions:

Insert Top Rider Before Inserting Side Signs

Stand the frame on the ground, spreading open the sign faces only half way. Place the Sign Rider in the opening at the top between the sign faces. Now, move the sign faces apart until fully extended.

You may want to cut a hole in the rider to make the handle accessible.

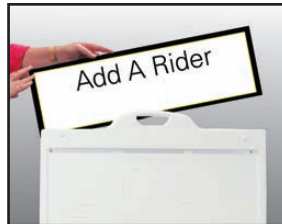

Side Signs Insertion Instructions:

A cutting template is available at plasticade.com.

Holds signs up to 1/4" thick.

If using corrugated plastic sheet for side signs, cut so flutes run horizontal to ground.

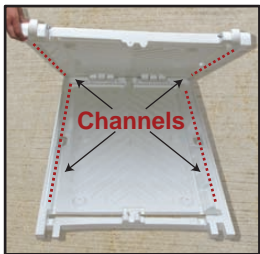

1. Lay frame flat on the ground. Lift up the top sign face.

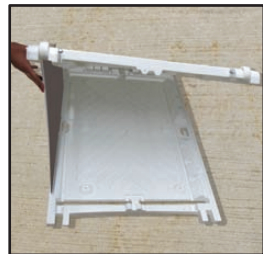

2. Slide first Side Sign into top and bottom channels on one side of frame.

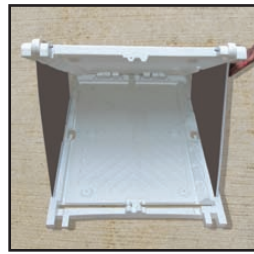

3. Slide second Side Sign into top and bottom channels on other side of frame.

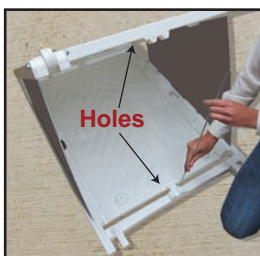

4. Insert Stabilizing Bar into hole on bottom and top. Lift up sign frame by the handle to stand upright.

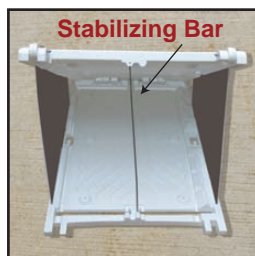

Sand Ballasting Instructions

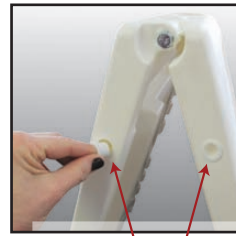

Sand Fill Holes

There are two holes for filling the sign frame with sand.

Remove plug from hole, fill with sand and then replace plug. Shake the sign frame to evenly distribute the sand at the bottom of the frame. 5 lbs. of sand per hole is recommended, for a total of 10 lbs.

Play sand is suggested for ease of filling.

Main Signs

Holds Signs
36"W x 48"H
(up to 3/16" thick)

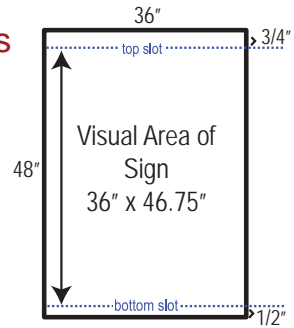

Stabilizing Bar

Use the Stabilizing Bar to prevent the spreading of the sign faces too far.

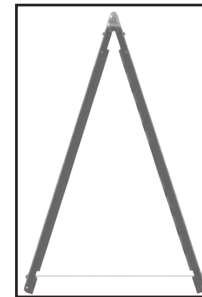

Bar in use

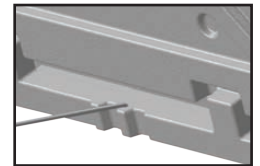

Place bar in holes at bottom of the sign frame to use.

PLASTICADE®

100 Howard Avenue
Des Plaines, IL 60018
phone (800) 772-0355
fax (847) 966-8074
Plasticade.com

MADE IN THE USA
US PATENTS
7,337,569 & 7,748,151

